

# CavitySliders™

## Assembly & Installation

### CS Cavity Slider™ Kitset Pocket Frame

Watch  
Video:



### Tools Required - Assembly

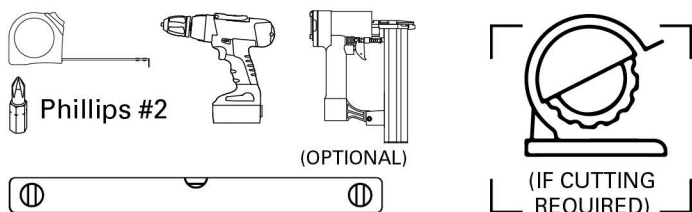

#8 screws and appropriate anchors required for installation

### Tools Required - Trim Fitting

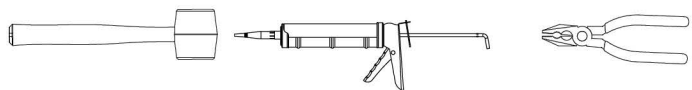

### Safety Gear Required



### Parts List

- Corner Joining Bracket (8)
- Split Jamb Joining Bracket (4)
- Slat Joining Bracket (12)
- #8 x 33/64" (13mm) Self Drilling Gold Plate (32)
- #10 x 35/64" (14mm) Self Tapping Zinc Plate (36)
- 1/4 Crown x 3/8 Leg" 18-Gauge Finish Staple (32)
- Foam Stop (2)
- Bi-Parting Pin
- T-Guide Base
- Block Clip (12)
- Short T-Guide
- Trim Clip (16)
- Long T-Guide
- Setting Block - Used for:
  - Positioning soft close activator
  - Spreading & holding jambs in place

### Cut Extrusions to Length as Required



Dimensions below suit 3/4" (19mm) jamb thickness

DW = Door Width DH = Door Height

If cutting the Track ensure you do **not** cut the notched end

- A** Back Stud x1 DH + 2 7/8" (DH + 74mm)
- B** Split Jamb *Door size: 2'0"x 6'8" to 3'0"x 6'8"* x2 DH + 2 11/16" (DH + 68mm)
- B** Split Jamb *Door size: 2'0"x 8'0" to 4'0"x 8'0"* x2 DH + 2 11/16" (DH + 68mm)
- C** Track x1 DW x 2
- D** Bottom Plate x1 DW - 1/8" (DW - 3mm)
- E** Slat *Door size: 2'0"x 6'8" to 3'0"x 6'8"* x6 DW - 4" (DW - 101.5mm)
- E** Slat *Door size: 2'0"x 8'0" to 4'0"x 8'0"* x6 DW - 5 9/16" (DW - 141.5mm)
- F** Top Fixing Block x2 DW + 1/8" (DW + 3mm)
- G** Bottom Fixing Block *Door size: 2'0"x 6'8" to 3'0"x 6'8"* x2 DW - 7 1/2" (DW - 190mm)
- G** Bottom Fixing Block *Door size: 2'0"x 8'0" to 4'0"x 8'0"* x2 DW - 9" (DW - 230mm)

### Rough Opening (RO)

| Dimension             | inches        | mm          |
|-----------------------|---------------|-------------|
| RO height (ROH)       | DH + 4 1/4"   | DH + 108    |
| RO width - Single     | (DW x 2) + 2" | (DWx2) + 51 |
| RO width - Bi-Parting | (DW x 4) + 2" | (DWx4) + 51 |

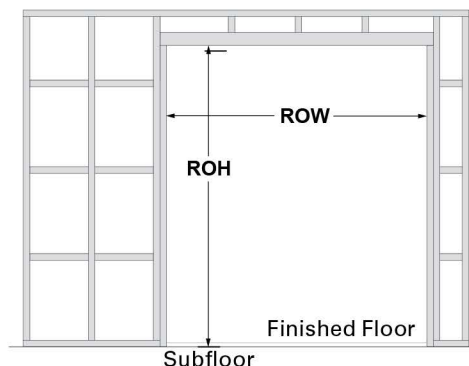

## Assembly

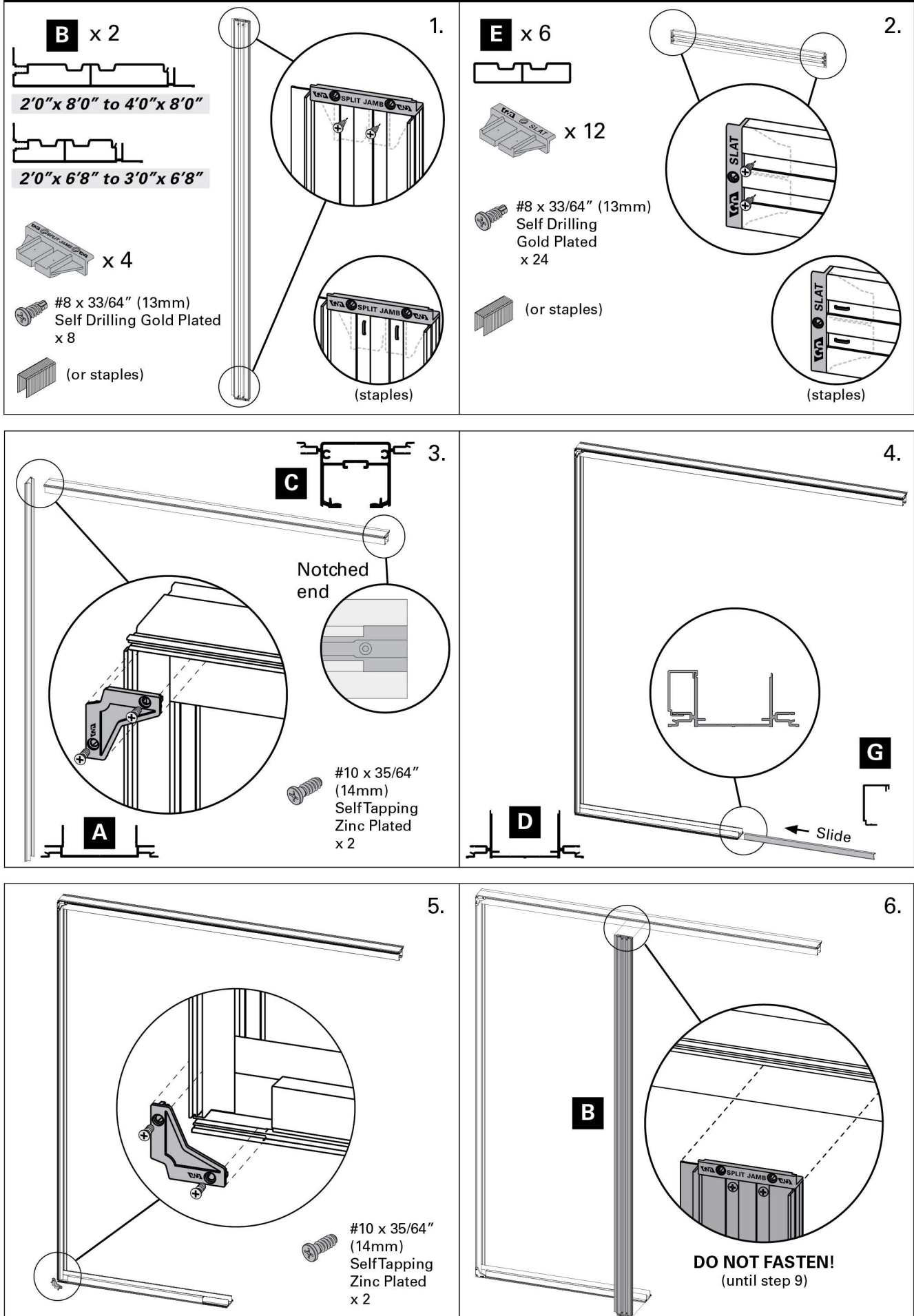

# Assembly

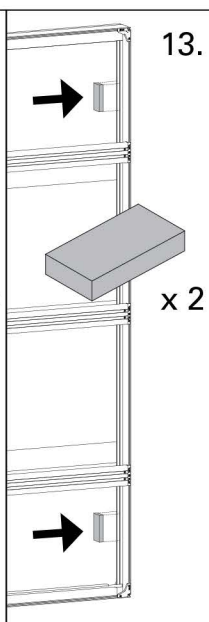
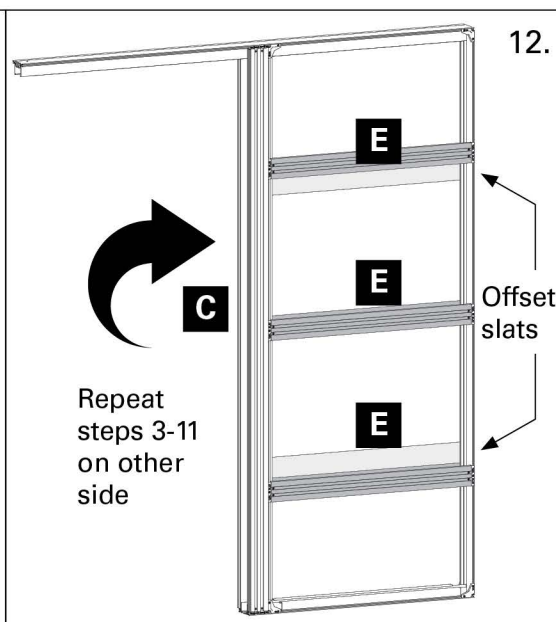
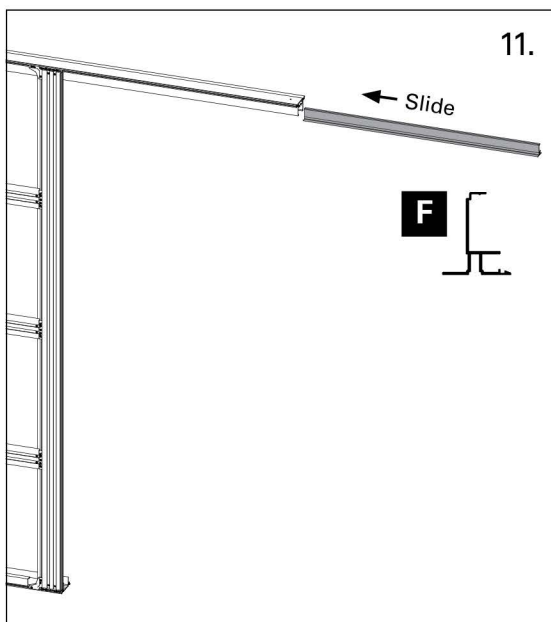
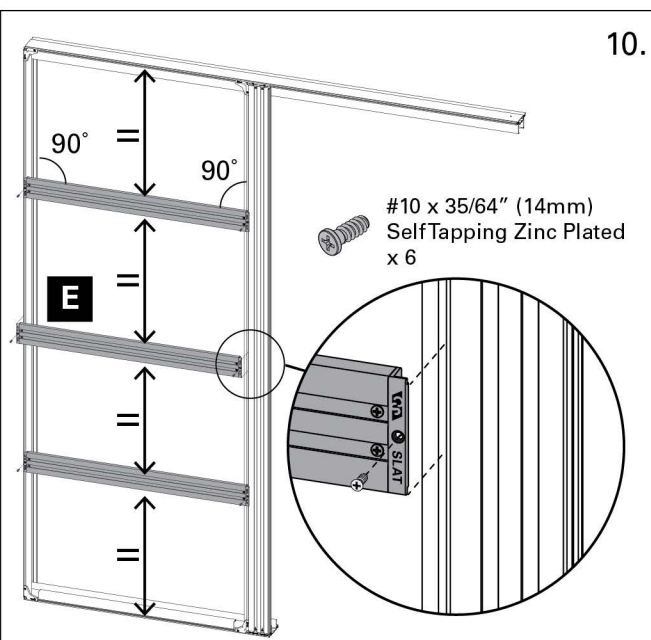
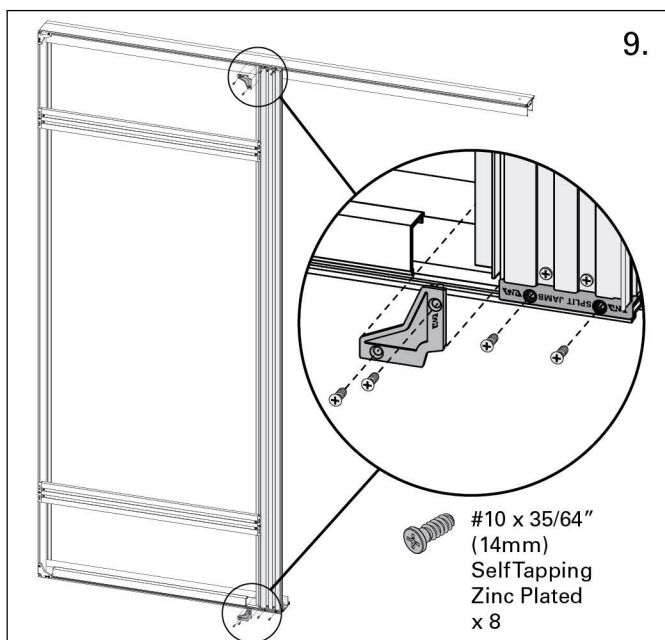
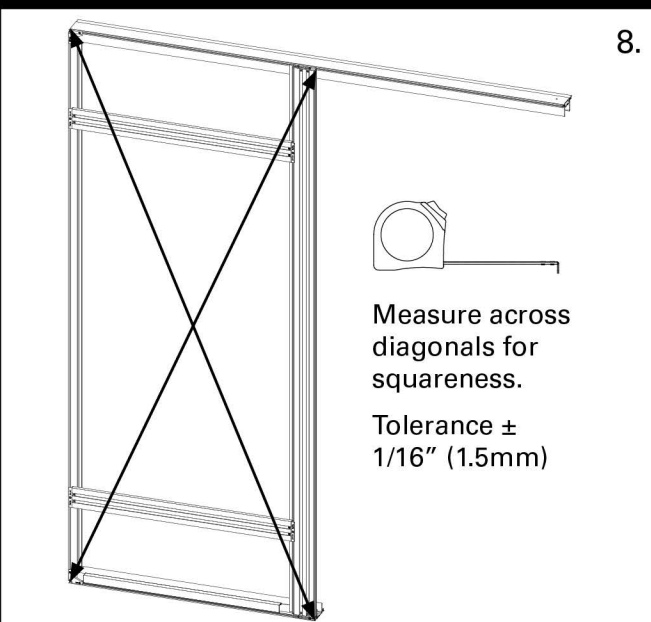
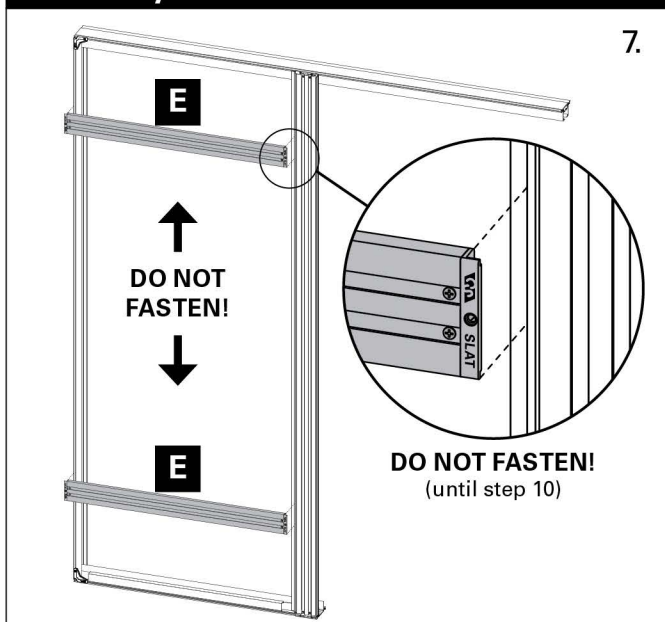



## Assembly

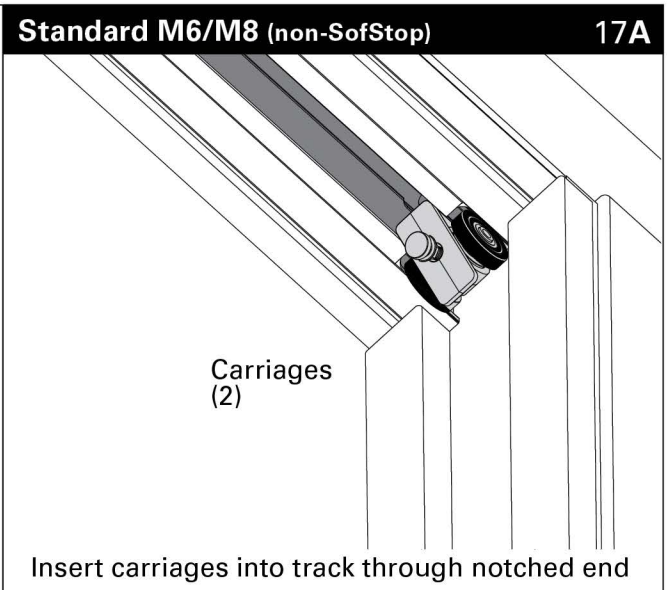
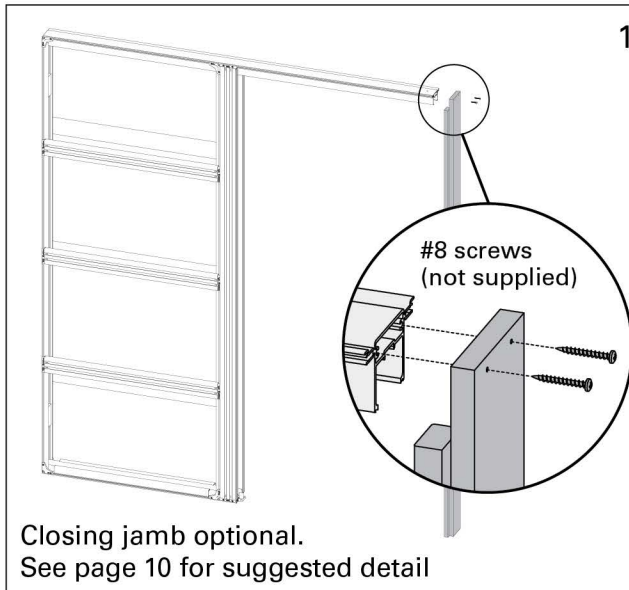
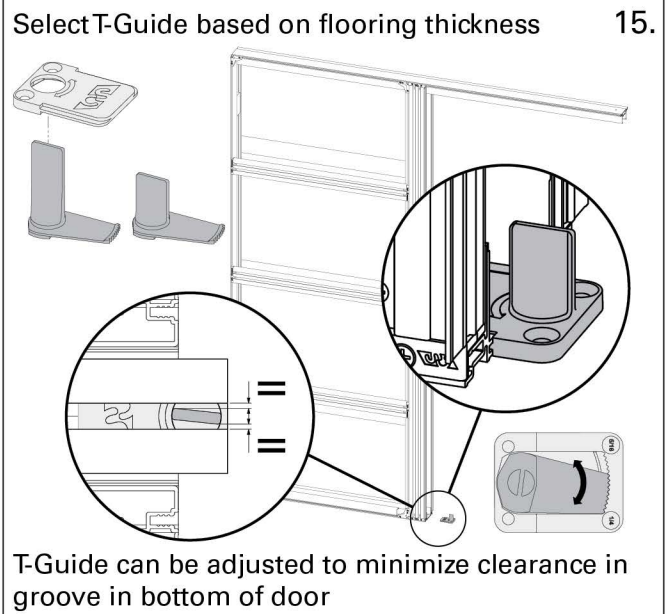
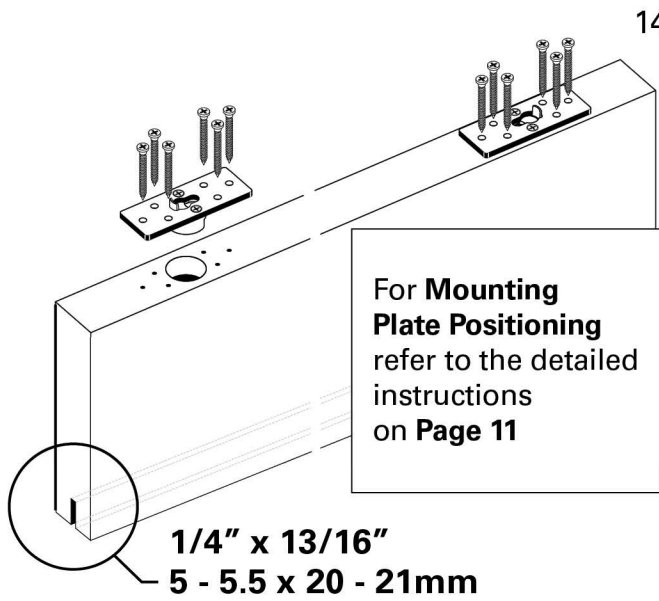

## SofStop® Single (Soft Close)

17B

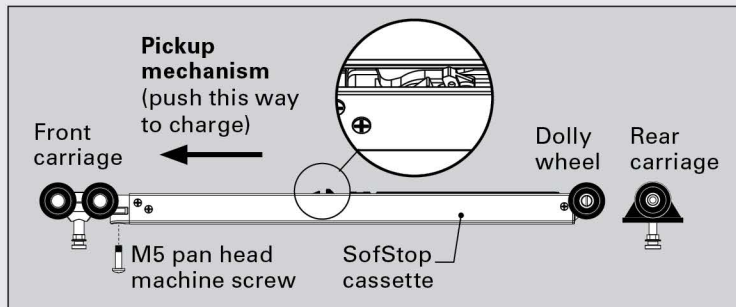

a) Single SofStop mechanism fits together as shown above. Push pickup mechanism in direction shown to charge it.

**Watch Video:**  
**SofStop Installation**  
**and Trouble Shooting Tips**

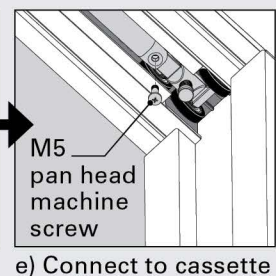
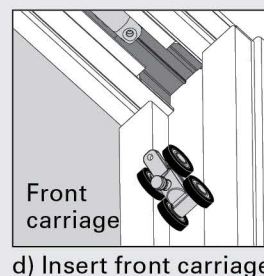
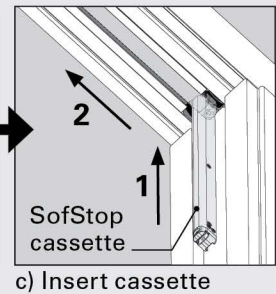
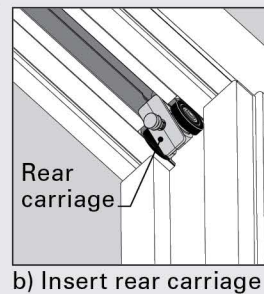

**DO NOT DRYWALL THE POCKET UNTIL THE SOFSTOP MECHANISM HAS BEEN INSTALLED & TESTED.**

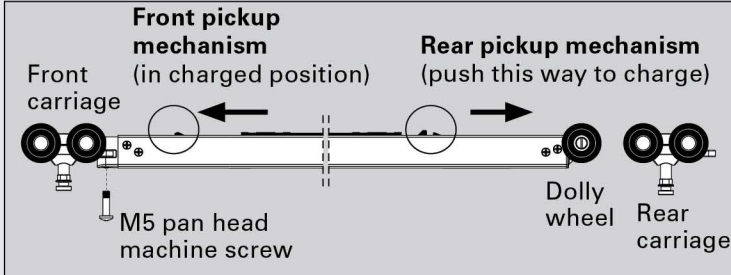

a) The twin SofStop mechanism fits together as shown above. **Push front and rear pickup mechanisms in the direction shown to charge.**

**Watch Video:**  
**SofStop Installation**  
**and Trouble Shooting Tips**

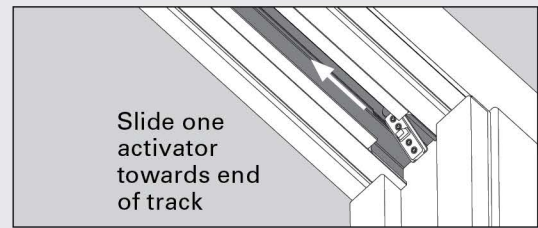

Slide one activator towards end of track

b) Insert one activator into track notch and slide towards end of track. **Do not tighten screws - this position is temporary.**

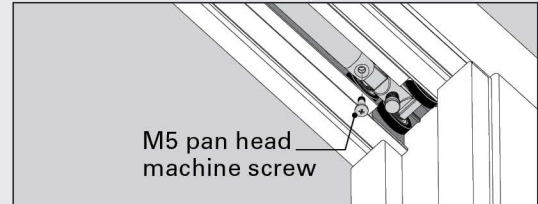

M5 pan head machine screw

c) Insert rear carriage, cassette and front carriage using same method as Single Sofstop (17B). Secure carriage to cassette.

## Installation

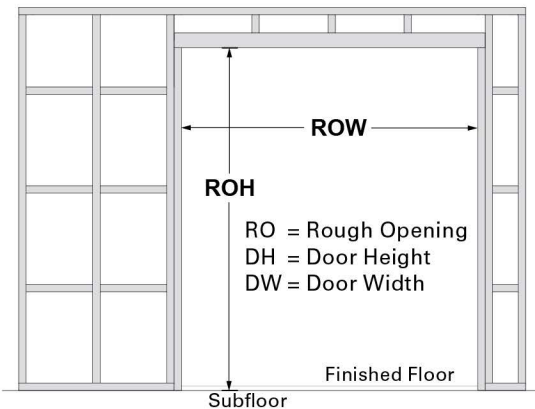

| Dimension             | inches        | mm          |
|-----------------------|---------------|-------------|
| RO height (ROH)       | DH + 4 1/4"   | DH + 108    |
| RO width - Single     | (DW x 2) + 2" | (DWx2) + 51 |
| RO width - Bi-Parting | (DW x 4) + 2" | (DWx4) + 51 |

### Hang the door.

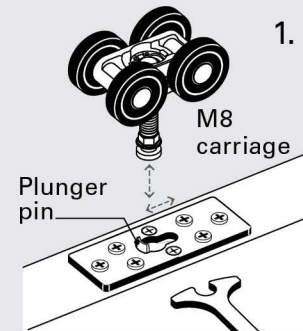
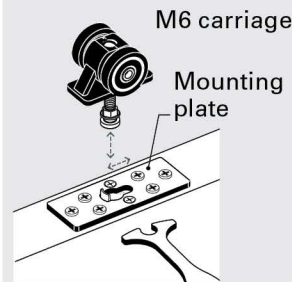

Position carriages in track above the door opening. Slide door over T-Guide. Raise door up so that hanger shaft lines up with hole in mounting plate. Depress plunger using wheel hanger shaft head and slide sideways using adjusting wrench until it snaps into locked position. Repeat for the other carriage.

**If you do not have your door at time of frame installation, we suggest hanging a dummy door of the same size to ensure the frame is plumb, level & square**

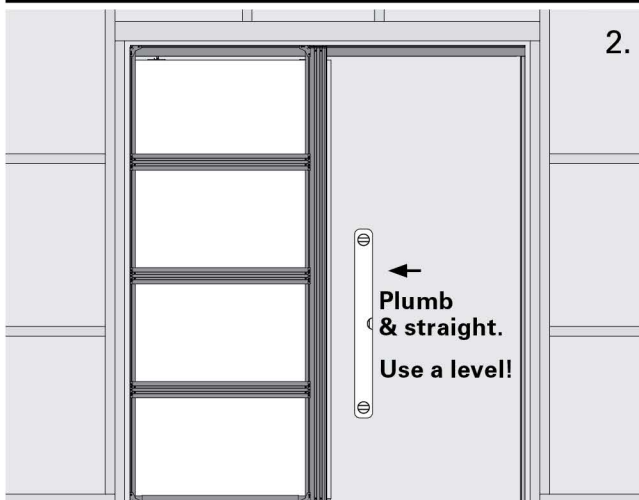

Place unit into rough opening. Plumb split jambs

### Bi-Parting units only

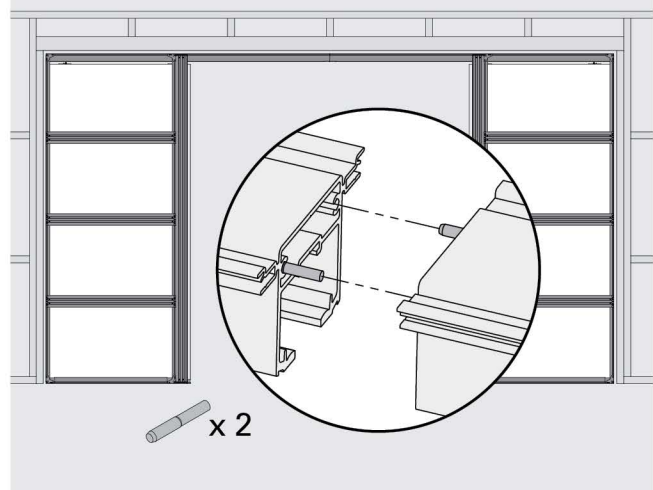

## Installation

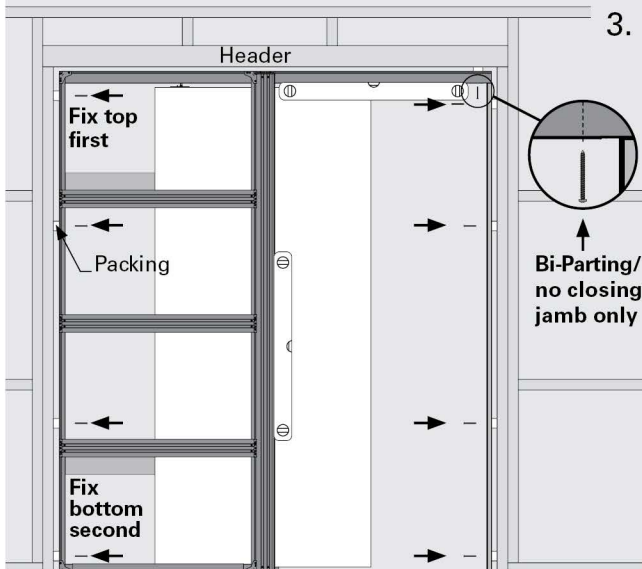

Keep plumb and pack where required.  
Fix back stud and closing jamb (if using) with #8 countersunk screws (not supplied).  
Bi-Parting units or units with no closing jamb need to be fixed to the header through the pre drilled hole, otherwise **DO NOT** fix through the track.

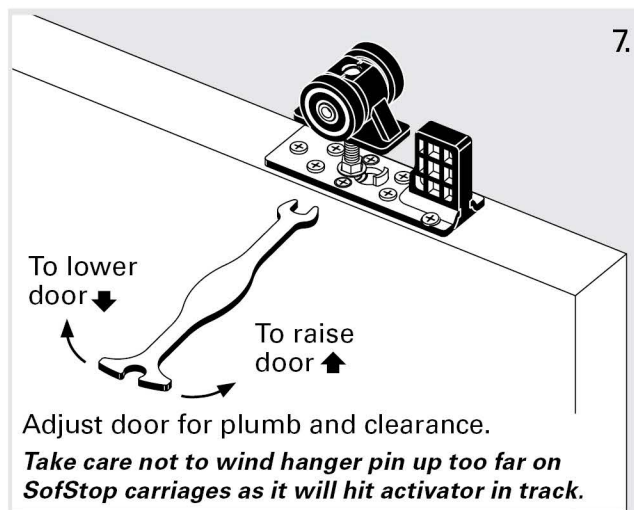
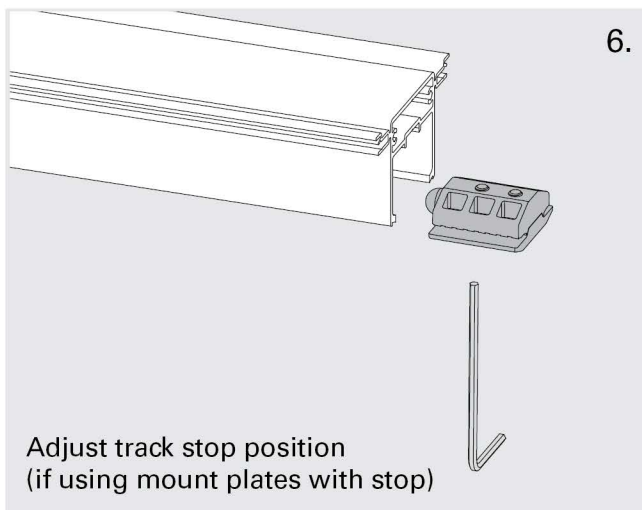
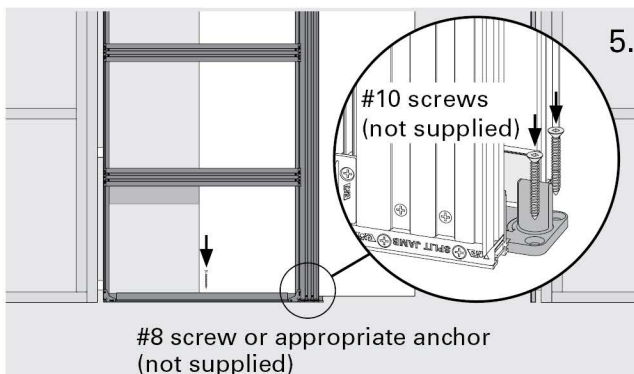
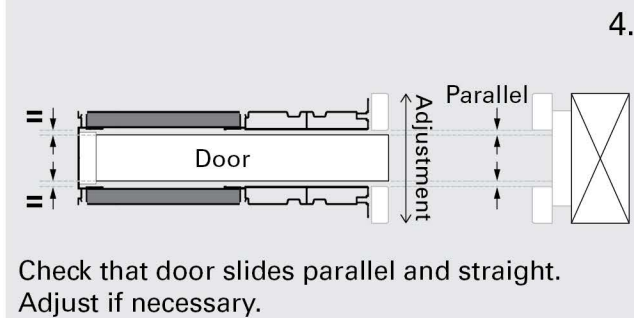

## SofStop® Single & Twin

Watch  
Video:



SofStop  
Installation  
and Trouble  
Shooting Tips



**Set front activator position.**

**Note:** *Single Soft Close* requires one front activator only.  
*Twin Soft Open & Close* requires two activators. One should already be in the track above the pocket (**Page 5**).

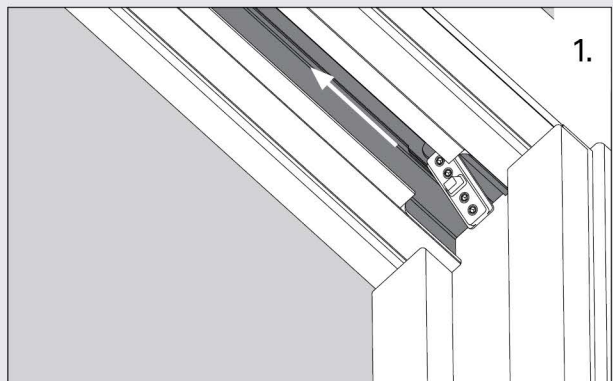

Slide activator to centre of door opening



## SofStop® Single & Twin

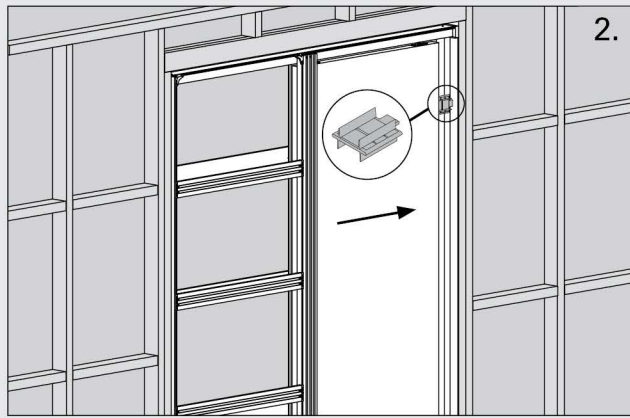

Hold setting block on closing jamb/finished wall and gently close door. Activator will slide to correct position. Securely tighten set screws on activator.

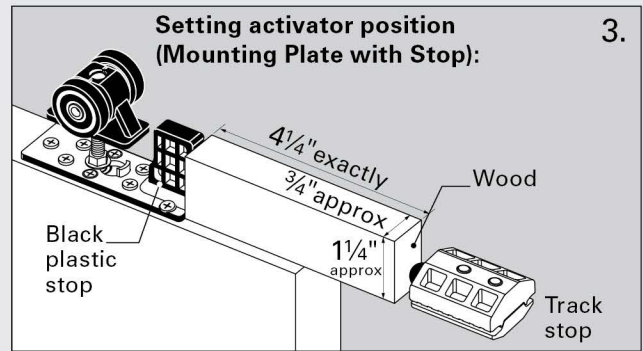

Cut piece of wood to 4-1/4" (108mm) and insert it above door, hard up against black plastic stop on mounting plate. Slowly close door until wood hits rubber part of track stop. Open door and securely tighten set screws on activator.

**WARNING:** If the door soft closes, but does not come to a stand still on a strike jamb, closing jamb or track stop, you risk breaking the hook on the soft close mechanism. If you use the activator setting block correctly this will be avoided.

## SofStop® Twin ONLY

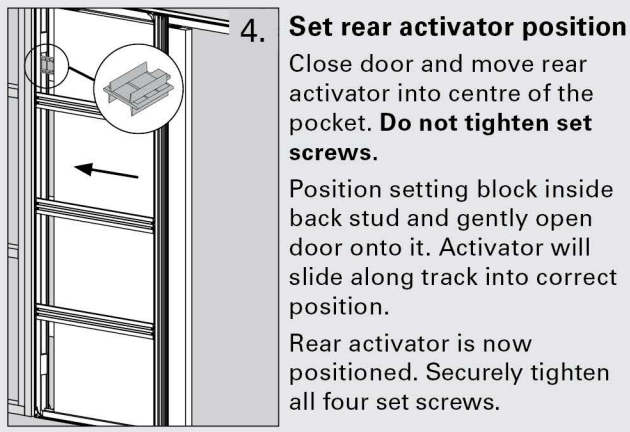

### 4. Set rear activator position

Close door and move rear activator into centre of the pocket. **Do not tighten set screws.**

Position setting block inside back stud and gently open door onto it. Activator will slide along track into correct position.

Rear activator is now positioned. Securely tighten all four set screws.

## Trim

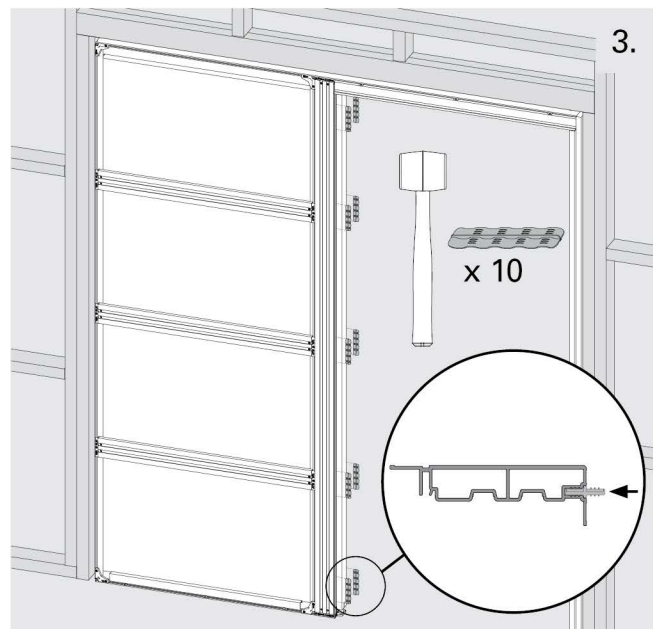
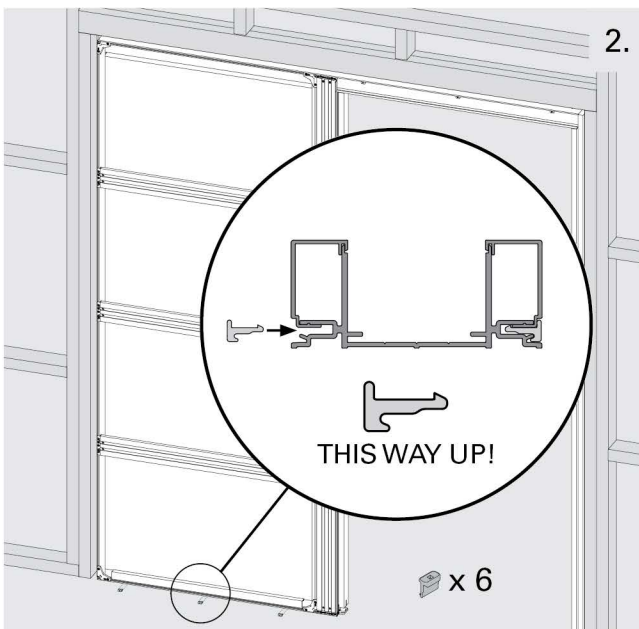
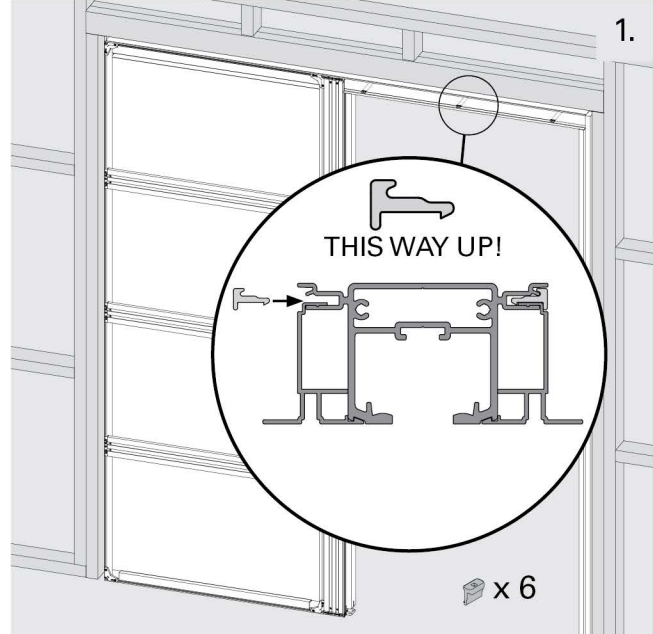

## Trim/Finishing

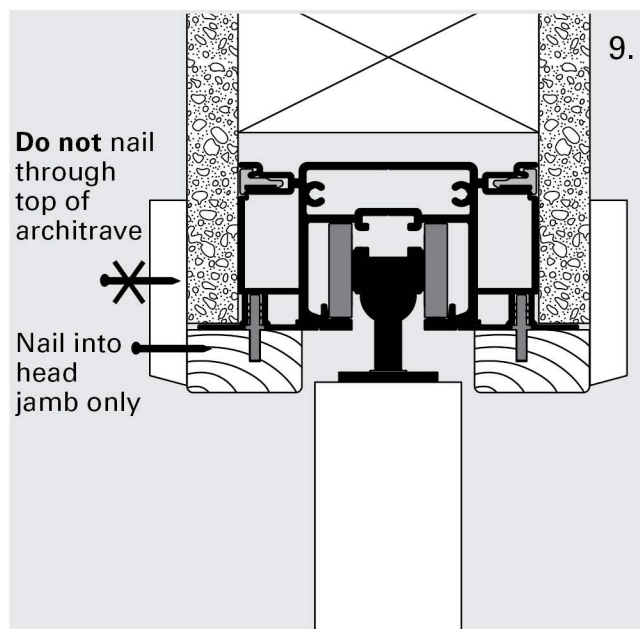
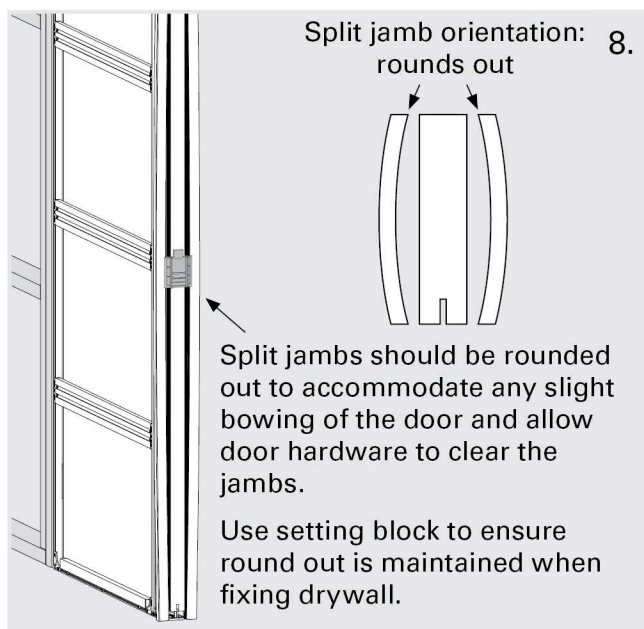
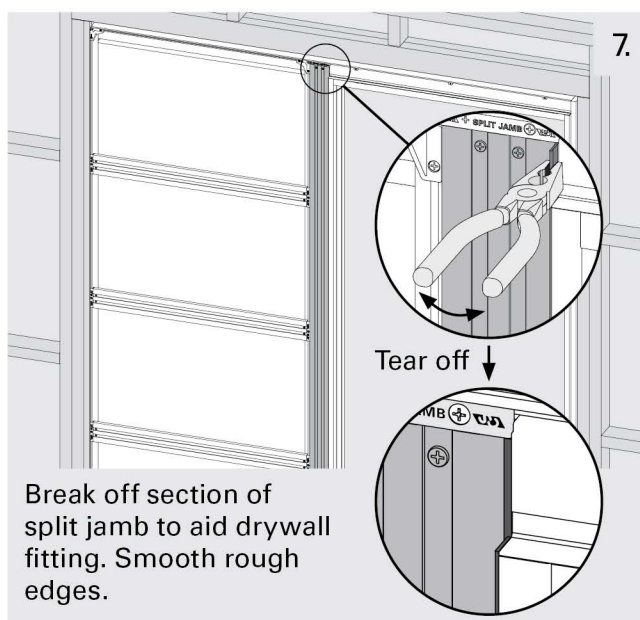
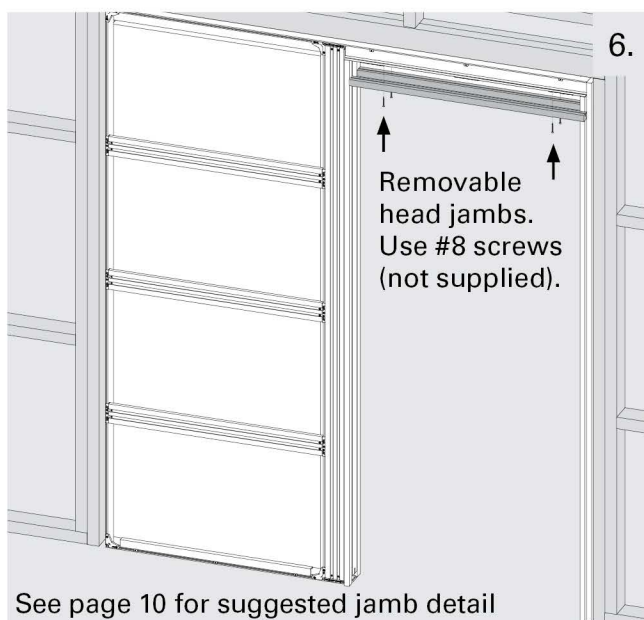
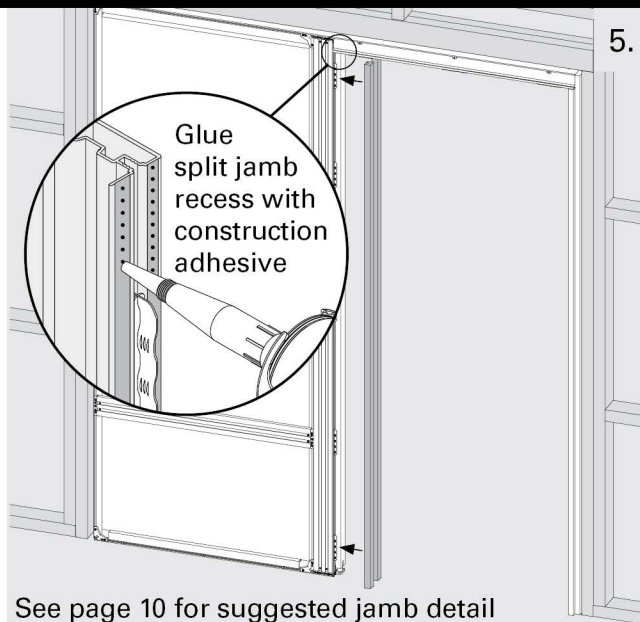
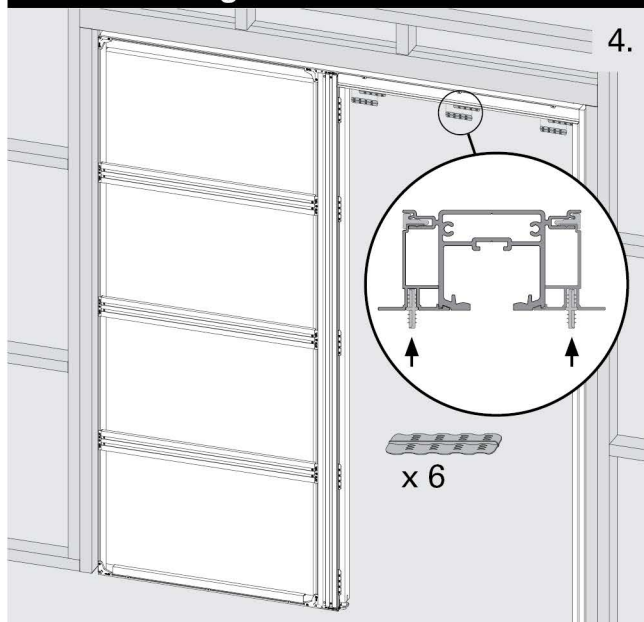



## Trim/Finishing

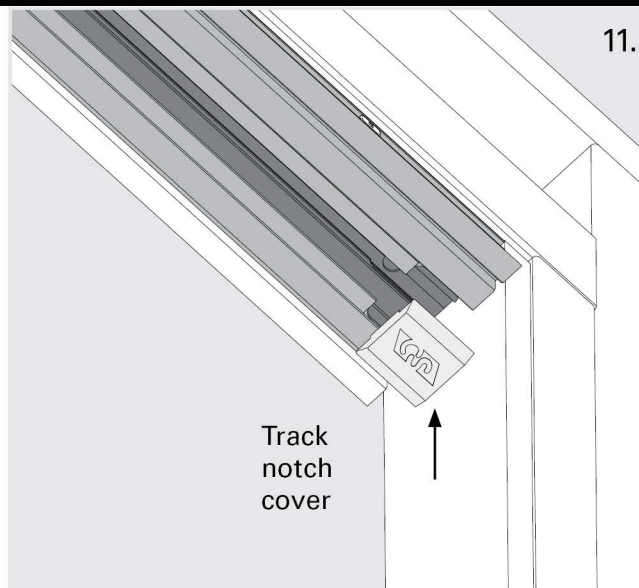
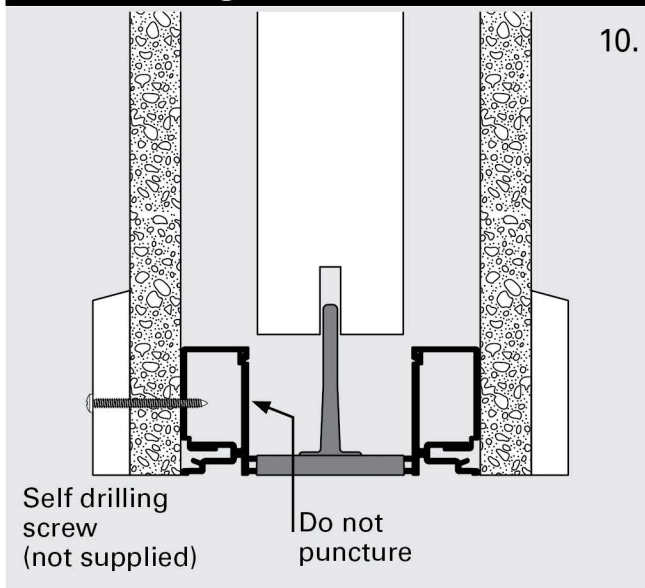

## Removing Door

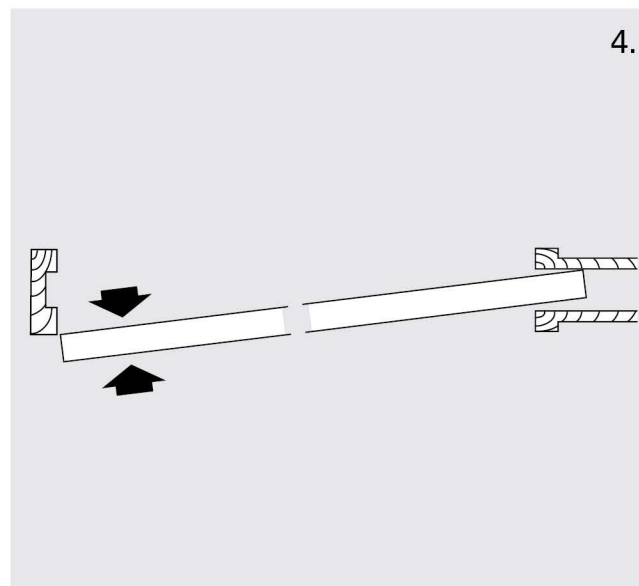
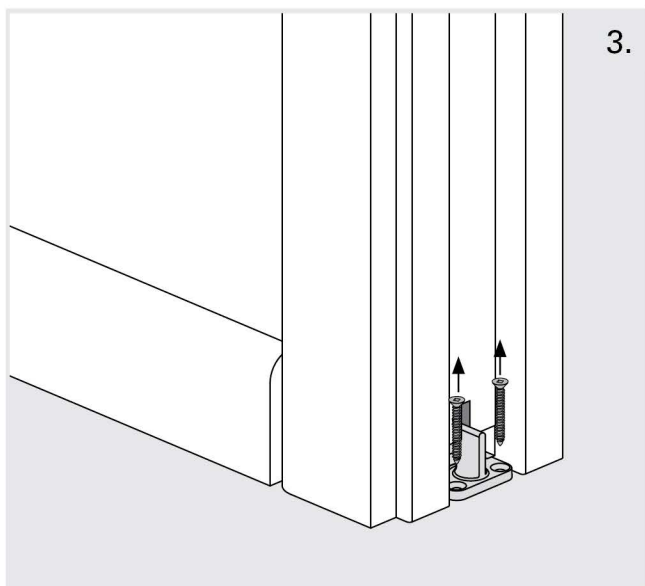
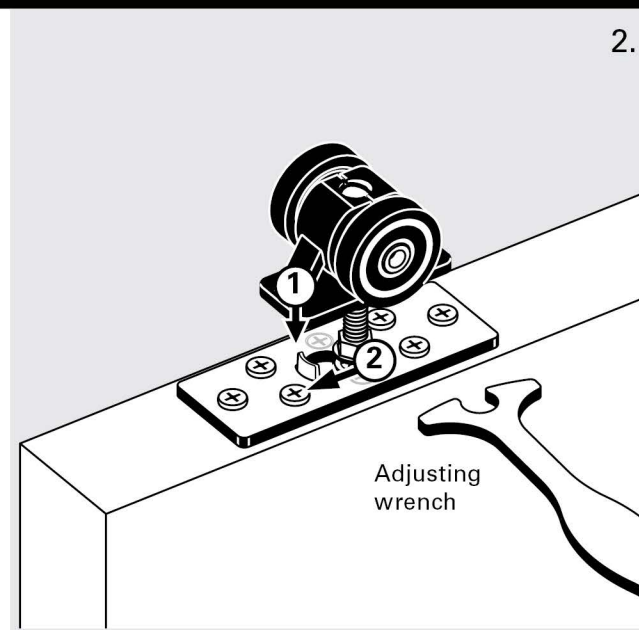
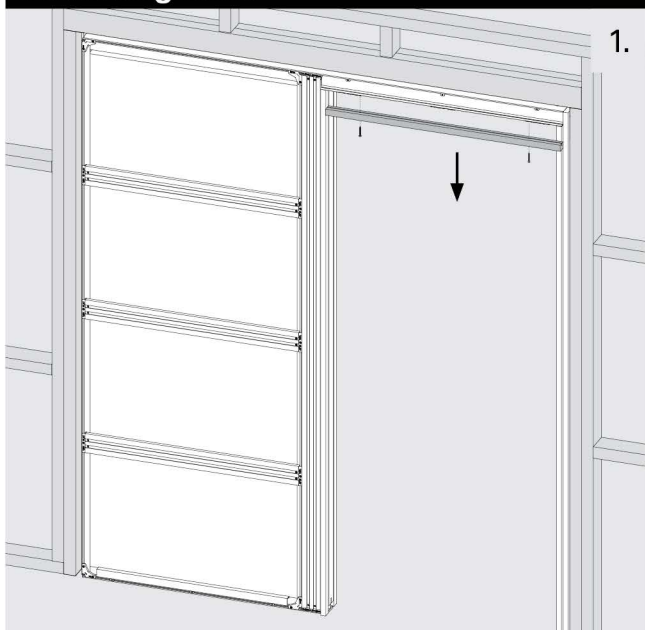

## Suggested Wooden Jamb Detail

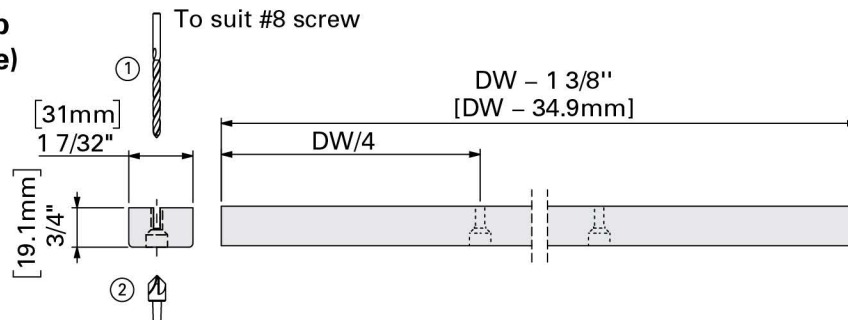
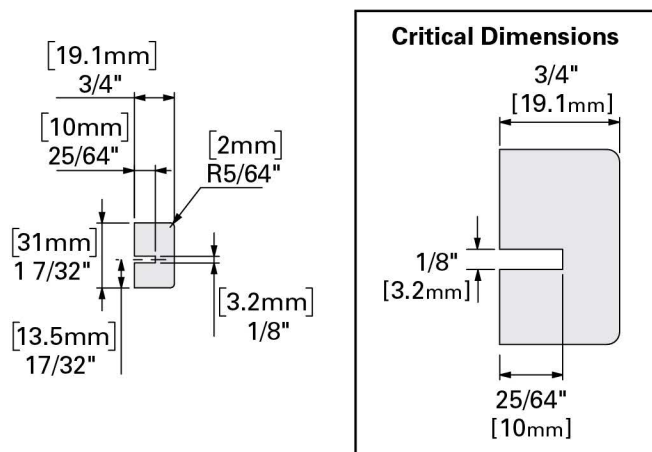
Head Jamb  
(removable)Split Jambs & Head Jambs  
(1 3/4" Door with 1/2" Drywall)

## Closing Jamb

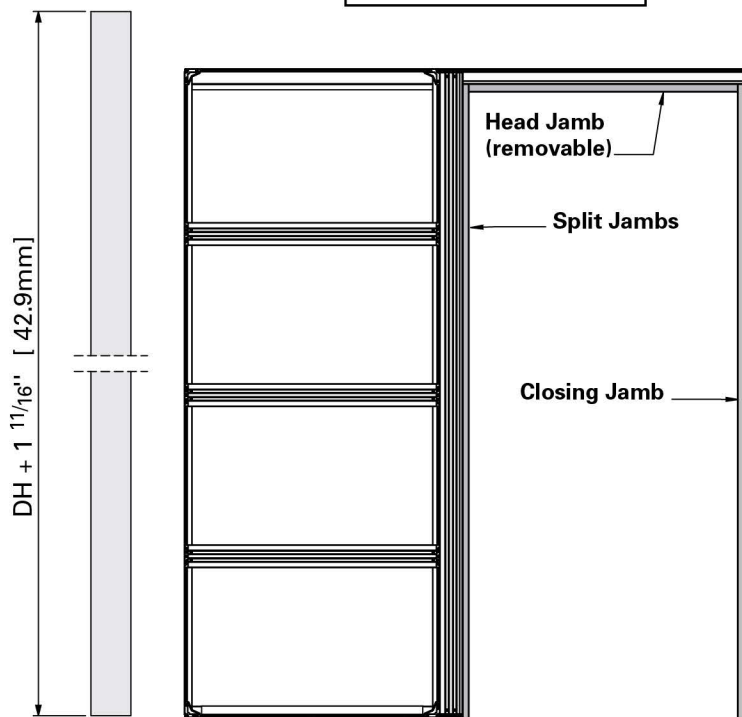
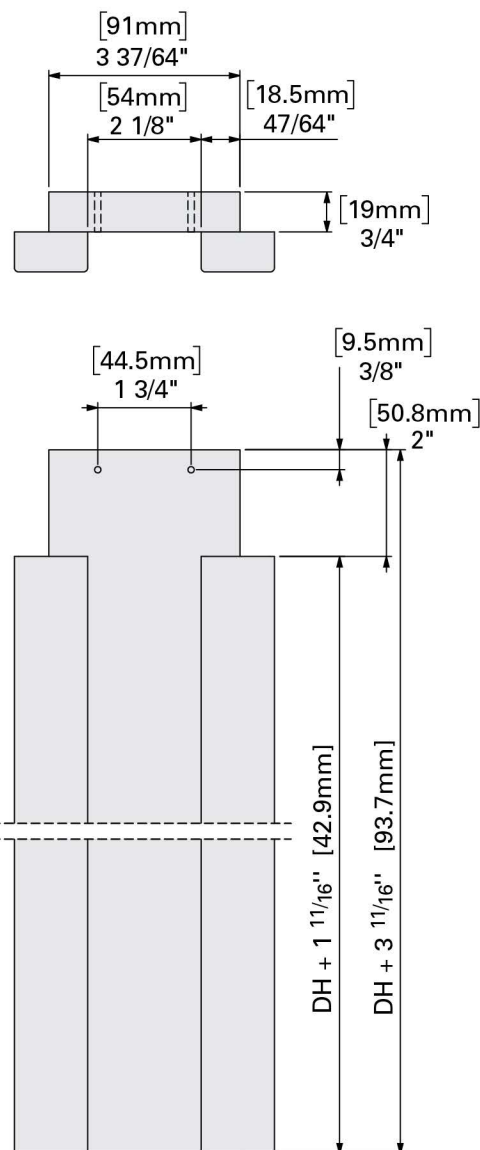

## Door Groove Detail

1/4" x 13/16"  
5 - 5.5 x 20 - 21mm

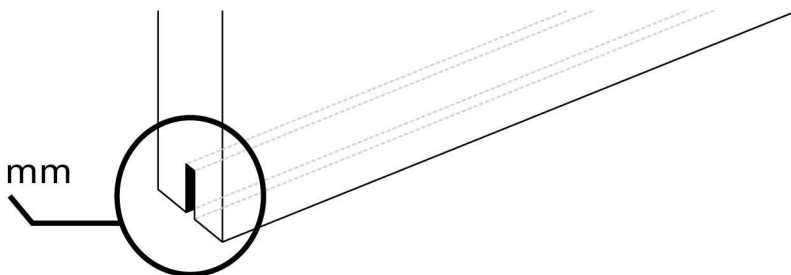

# Mounting Plate Positioning



Mounting Plate



Mounting Plate with Stop

## Single Door Mounting Option 1

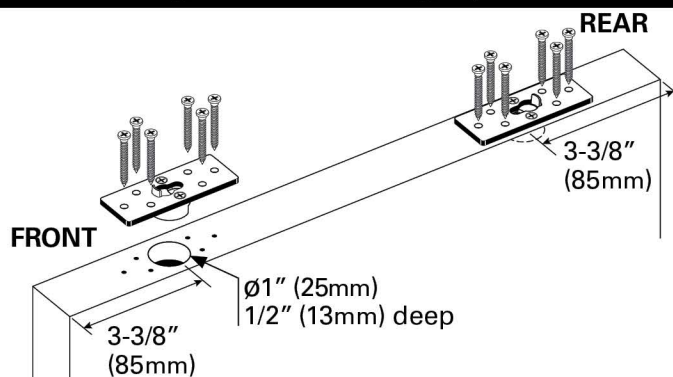

## Single Door Mounting Option 2

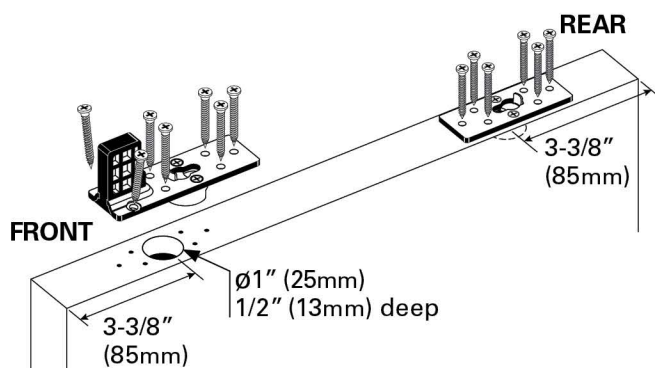

## Bi-Parting (Double Doors)

